

# FENCE POST

Surface Mount

Product Data

Size	6"x 6"x 36"h
Weight	30 lbs
Material	Steel
Anchoring	Surface Mount
Finish	Powder Coat
ProductNo.	End Post: MF5005 CenterPost:MF5006 CornerPost:MF5007

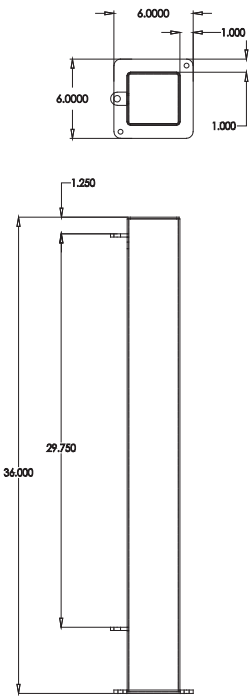

MF5005

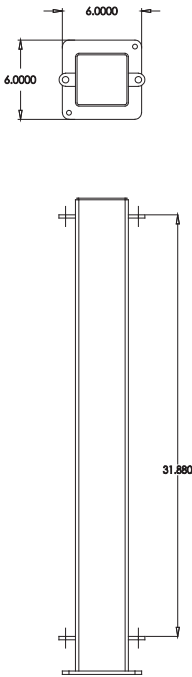

MF5006

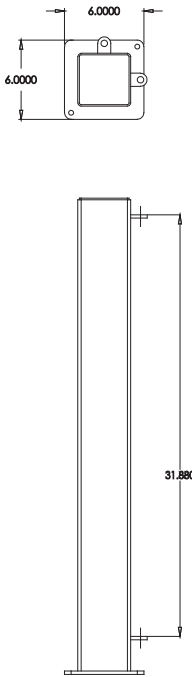

MF5007

Site Furnishings Limited Warranty:

For a period of two (2) years for concrete products, one (1) year for plastic products and five (5) years for metal products when the customer has received their product, Wausau Tile, Inc. warrants its concrete products against defects in workmanship and materials per industry standards. This warranty does not cover the above products for cracking and faulting caused by settling due to an improper base; nor does it cover damage caused by impact, vandalism or natural disaster.

# FENCE POST

Inground Mount

Product Data

Size	4"x 4"x 36'h
Weight	30 lbs
Material	Steel
Anchoring	IngroundMount
Finish	PowderCoat
ProductNo.	End Post: MF5008 CenterPost:MF5009 CornerPost:MF5013

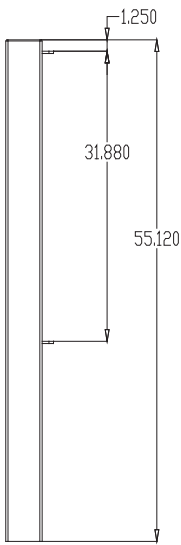
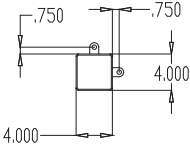
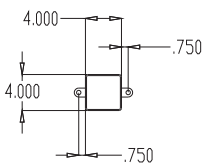
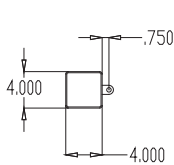

MF5008

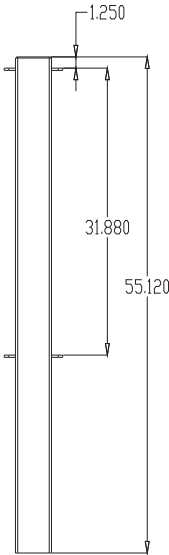

MF5009

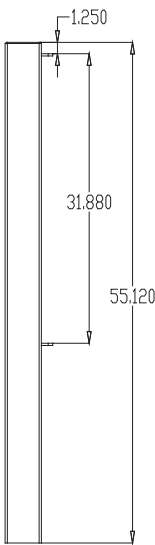

MF5013

Site Furnishings Limited Warranty:

For a period of two (2) years for concrete products, one (1) year for plastic products and five (5) years for metal products when the customer has received their product, Wausau Tile, Inc. warrants its concrete products against defects in workmanship and materials per industry standards. This warranty does not cover the above products for cracking and faulting caused by settling due to an improper base; nor does it cover damage caused by impact, vandalism or natural disaster.